

**HF**  
Halogen Free

REV	ECN NO.	LOCATION	DESCRIPTION	DATE	DESIGN
A			UPDATE	1/28'21	ZC.Xie

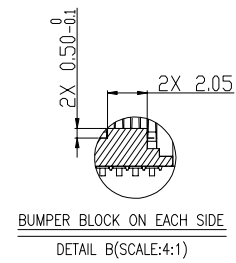
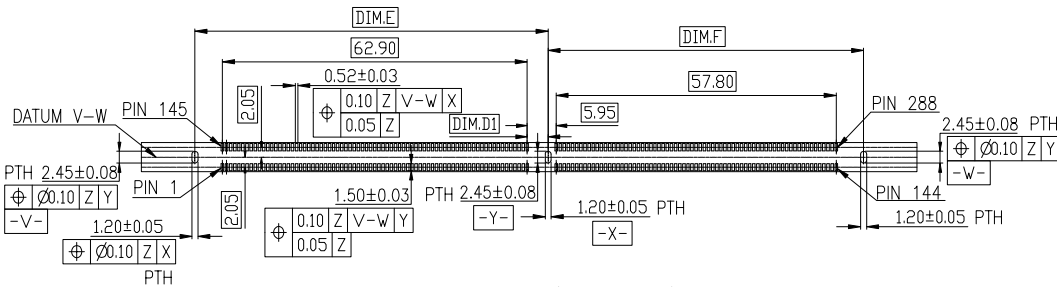
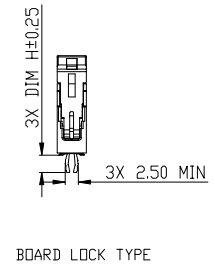
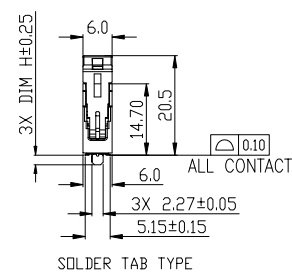
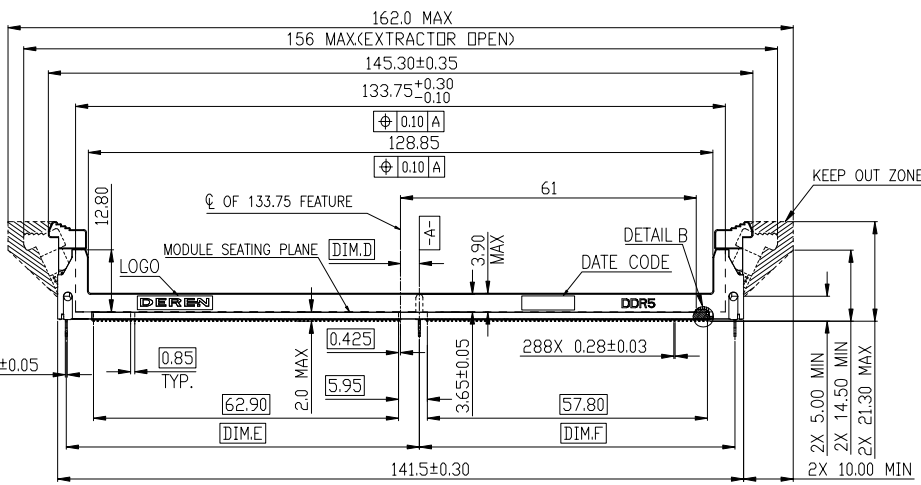
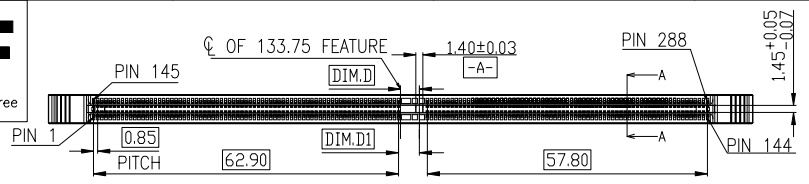

RECOMMENDED PCB LAYOUT(TOL:±0.05mm)

NOTES:  
Recommended stencil thickness no less than 0.15mm

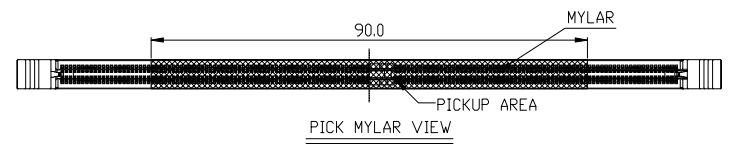
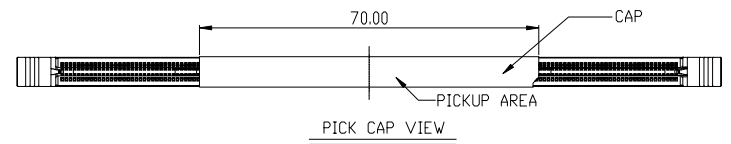

- NOTES:
- PRODUCT MUST MEET CONTROLLED SUBSTANCES SPEC. ROHS 2.0
  - MATERIAL:
    - HOUSING: NYLON , UL94V-0; COLOR: SEE P/N INFORMATION.
    - EXTRACTOR: NYLON ,UL94V-0; COLOR: SEE P/N INFORMATION.
    - CONTRACT: COPPER ALLOY .
    - FORK LOCK: STAINLESS STEEL.
    - METAL SHEET: STAINLESS STEEL
  - FINISH:
    - CONTACT:
      - GOLD PLATING(SEE SEE P/N INFORMATION.) ON CONTACT AREA.
      - 2.0um[80u"] MIN. MATTE-TIN PALTING ON SOLDER TAIL AREA.
      - 2.25um[90u"] MIN. NICKEL ON CONTACT AREA,
      - 1.27um[50u"] MIN. NICKEL ON OTHER AREA.
    - FORK LOCK:
      - MATTE TIN PALTING 80u"Min ON SOLDER TAIL AREA.
      - 50u" MIN. NICKEL UNDERPLATING OVERALL.
  - REFLOW SOLDER CAPABLE TO 260°C MAX. 10S.
  - MECHANICAL SPECIFICATION:
    - MATING FORCE: 106.8N MAX.
    - UNMATING FORCE: 19.77N MIN.
    - DURABILITY: 25 MATING AND UNMATING CYCLES
  - ELECTRICAL SPECIFICATION
    - CONTACT RESISTANCE: INITIAL:40 MILLIOHMS MAX., CONTACT RESISTANCE: FINAL: CHANGE 20 MILLIOHMS MAX..
    - CURRENT RATING: 0.75AMPS MAX.
    - INSULATION RESISTANCE: 1 MEGOHMS MIN. AT 500VAC
    - DIELECTRIC WITHSTAND VOLTAGE: 500VAC MIN. FOR ONE MINUTE.
  - ENVIRONMENT SPECIFICATION
    - OPERATING TEMPERATURE: -55°C TO +85°C.
    - SOLDERABILITY: PASSED PER EIA-364-52, CLASS 2, CATEGORY 3.
    - VIBRATION: PASSED PER EIA-364-28.
    - HUMIDITY: PASSED PER EIA-364-31.
    - THERMAL SHOCK: PASSED PER EIA-364-32.
    - MECHANICAL SHOCK: PASSED PER EIA-364-27.
  - PART NUMBER INFORMATION:

568QD1-001 H X X X X X

GREEN CODE:  
1: HALOGEN FREE

PLATING CODE:  
1:GOLD FLASH  
2:GOLD 15u"  
3:GOLD 30u"

HOUSING COLOR CODE:  
1: BLACK  
2: WHITE  
3: BLUE

EXTRACTOR COLOR CODE:  
1: BLACK  
2: WHITE  
3: BLUE

PACKAGE & PICKUP CODE:  
1: HARD TRAY PACKING,WITH CAP  
2: HARD TRAY PACKING,WITHOUT CAP/MYLAR  
3: HARD TRAY PACKING, WITH MYLAR

FORK LOCK & DIMM TYPE CODE:  
1: SOLDER TAB DIM.H=2.0mm, RDIMM  
2: BOARD LOCK DIM.H=3.25mm, RDIMM  
3: SOLDER TAB DIM.H=2.0mm, UDIMM  
4: BOARD LOCK DIM.H=3.25mm, UDIMM  
5: SOLDER TAB DIM.H=2.6mm, RDIMM  
6: SOLDER TAB DIM.H=2.6mm, UDIMM

DIMM TYPE	DIM.D	DIM.D1	DIM.E	DIM.F
RDIMM	3.875	4.30	72.85	65.10
UDIMM	1.425	1.85	70.40	67.55

DIM	TOL	DIM	TOL
x.	±0.35	x.	±2'
.x	±0.25	.x	±1'
.xx	±0.20		
.xxx	±0.15		



**DEREN**  
SHENZHEN DEREN ELECTRONIC CO., LTD

DRAW NO. SC2006325	DESIGN: Cay Zhao	DATE 11/17'20	TITLE: DDR5 288PIN SMT BIG EXTRACTOR
REV. A	CHECK: Bill Lin	DATE 11/17'20	P/N:SEE P/N INFORMATION
	APPROVAL: Smak Huo	DATE 11/17'20	SHEET: 1/3
			SCALE: 1:1 UNIT: mm

REV.	ECN NO.	LOCATION	DESCRIPTION	DATE	DESIGN
A			UPDATE	1/28'21	ZC.Xie

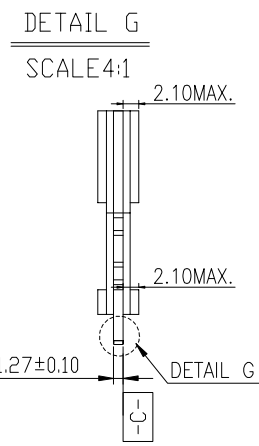
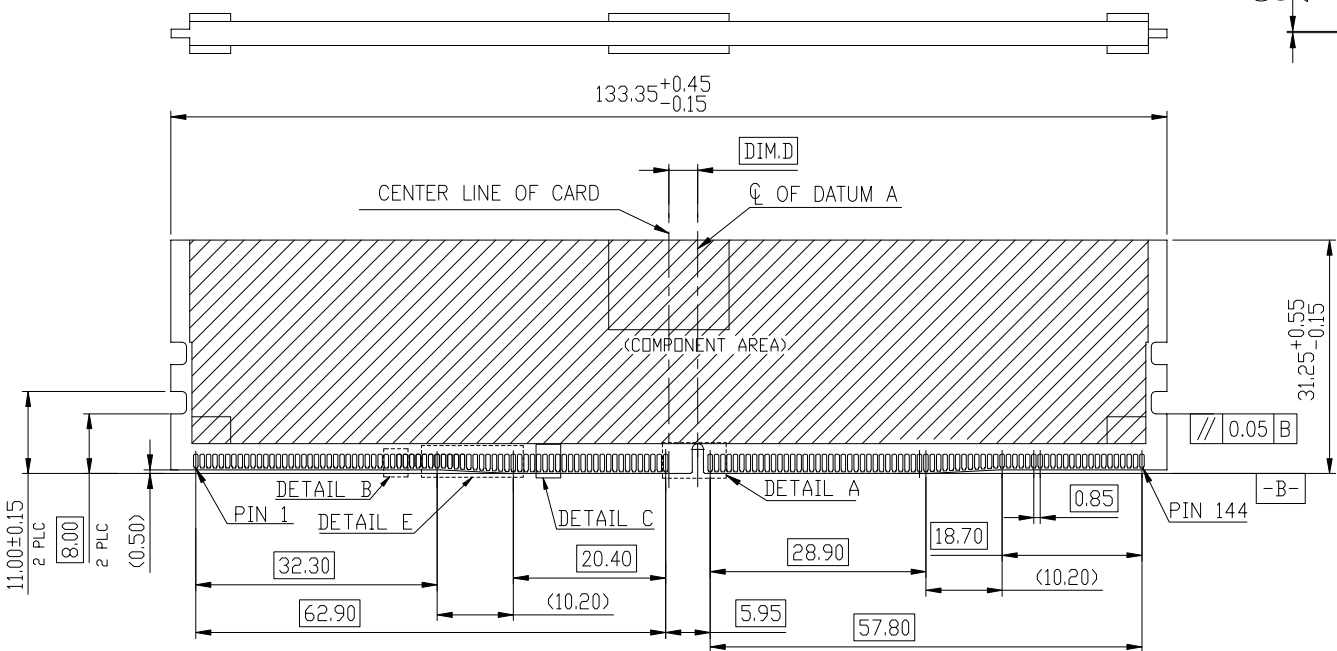
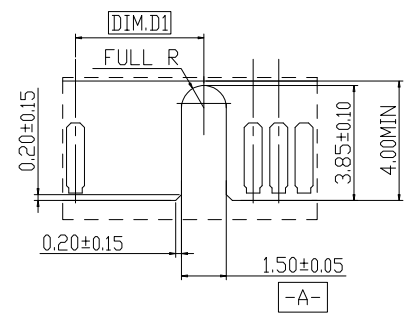
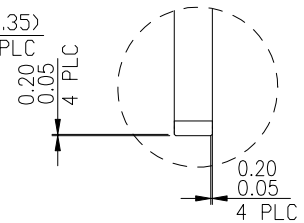
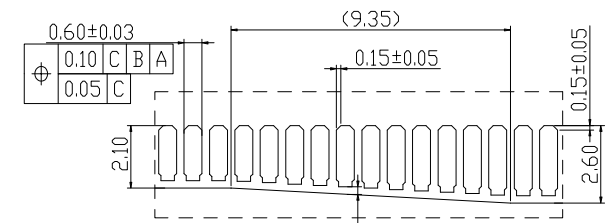
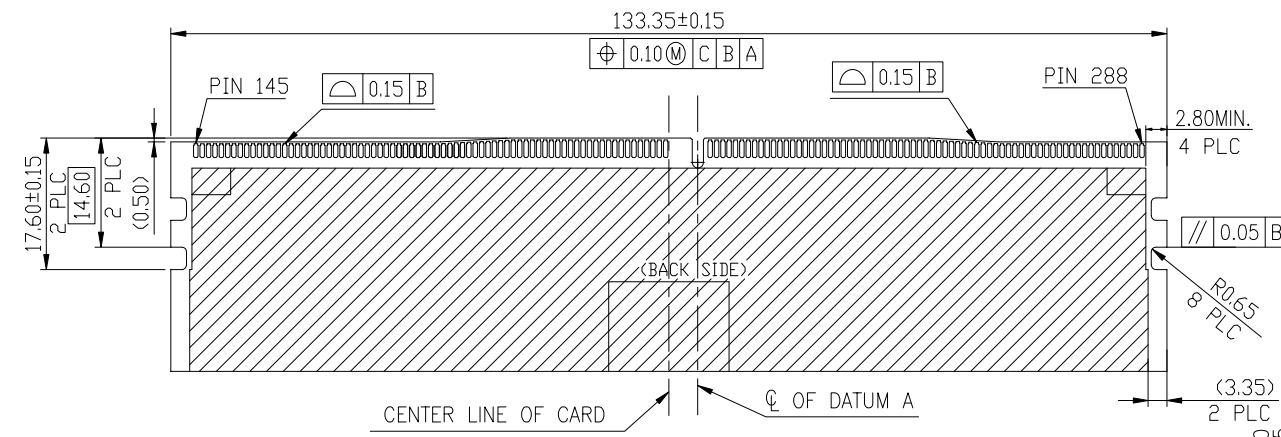

DETAIL A  
SCALE 4:1

DIMM TYPE	DIM.D	DIM.D1	DIM.E	DIM.F
RDIMM	3.875	4.30	72.85	65.10
UDIMM	1.425	1.85	70.40	67.55

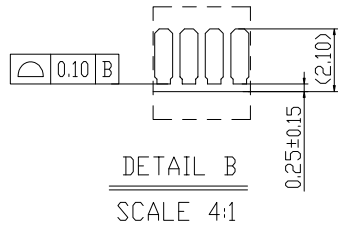
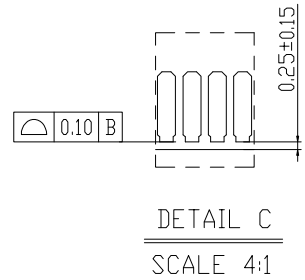

DIM	TOL	DIM	TOL
x.	±0.35	x.	±2'
.x	±0.25	.x	±1'
.xx	±0.20		
.xxx	±0.15		



**DEREN**  
SHENZHEN DEREN ELECTRONIC CO., LTD

CUSTOMER DRAWING	DATE	TITLE: DDR5 288PIN SMT BIG EXTRACTOR
DESIGN: Cay Zhao	11/17'20	P/N: SEE P/N INFORMATION
CHECK: Bill Lin	11/17'20	SHEET: 2/3
APPROVAL: Smark Huo	11/17'20	SCALE: 1:1 UNIT: mm

DRAW NO.	SC2006325
REV.	A

REV.	ECN NO.	LOCATION	DESCRIPTION	DATE	DESIGN
A			UPDATE	1/28'21	ZC.Xie

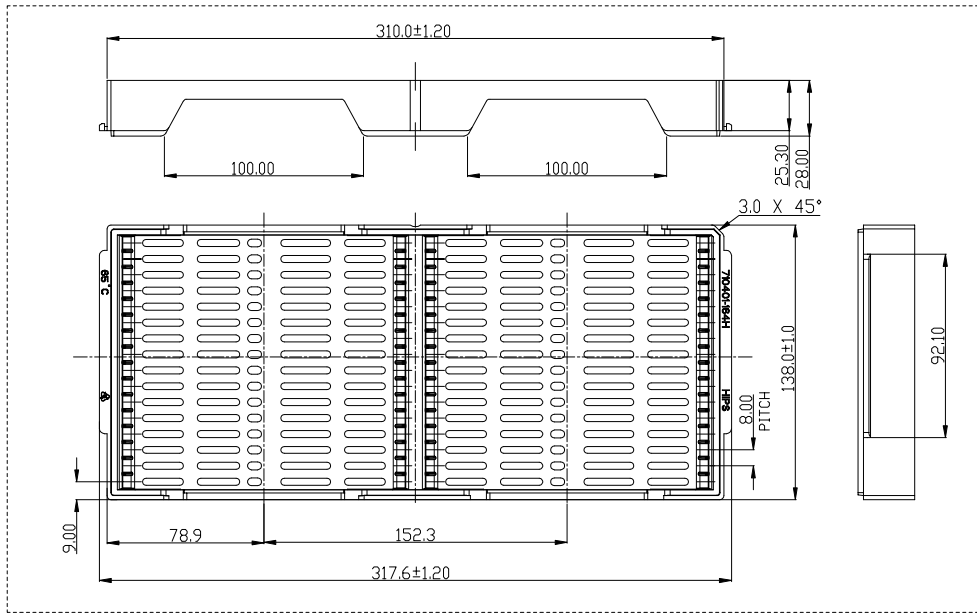
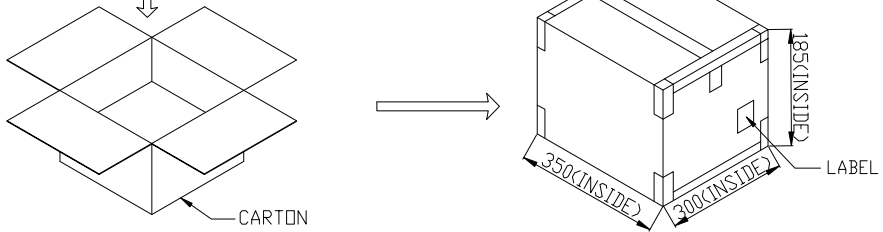
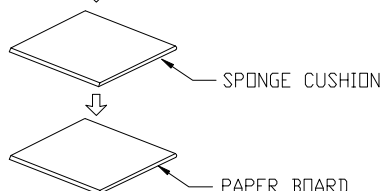
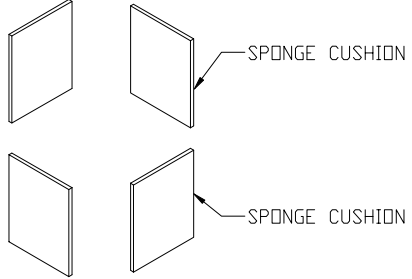
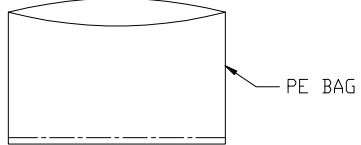
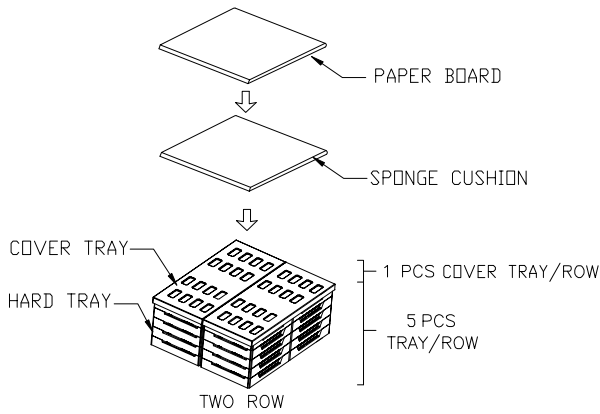

HARD TRAY VIEW

4.35kg	1.86kg	32	10	320
GROSS WEIGHT	NET WEIGHT	PCS/ TRAY	TRAY/ BOX	PCS/ BOX

DIM	TOL	DIM	TOL
.X	±1.00	.X	
.X	±0.50	.X	
.XX	±0.35		

**DEREN**  
SHENZHEN DEREN ELECTRONIC CO., LTD

DRAW NO.	DESIGN:	DATE:	TITLE:
SC2006325	Cay Zhao	11/17'20	DDR5 288PIN SMT BIG EXTRACTOR
REV. A	CHECK:	11/17'20	P/N: SEE P/N INFORMATION
	Smak Huo	11/17'20	SHEET: 3/3
	APPROVAL:		SCALE: 1:1
			UNIT: mm