

HF

Halogen Free

REV.	ECN NO.	LOCATION	DESCRIPTION	DATE	DESIGN
X1			INITIAL RELEASE	2019.02.27	Liangkeyao
					Liangkeyao

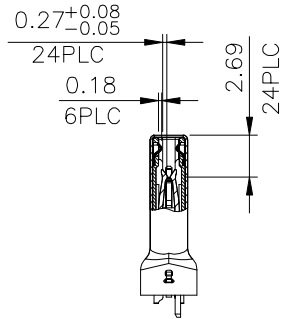
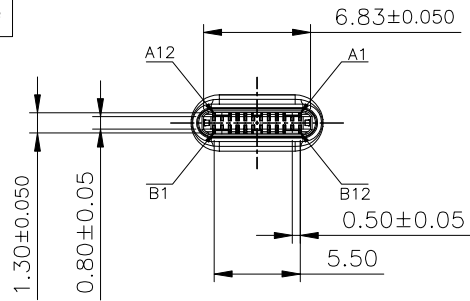

SECTION B-B
SCALE 1:1
(WITH EMI SPRING)

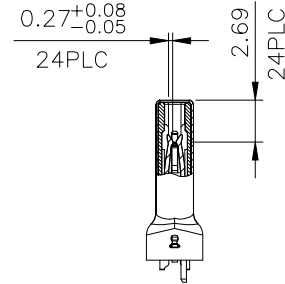

SECTION B-B
SCALE 1:1
(WITHOUT EMI SPRING)

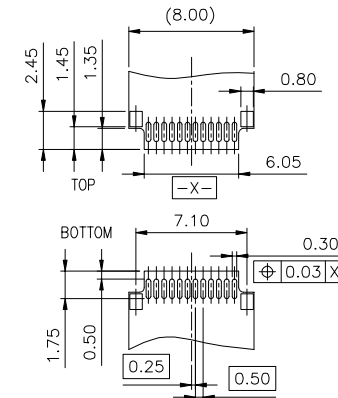
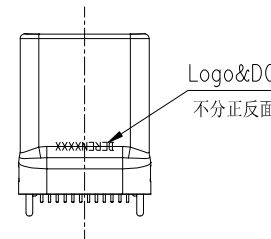
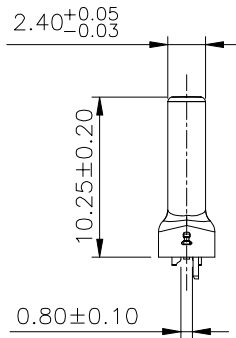
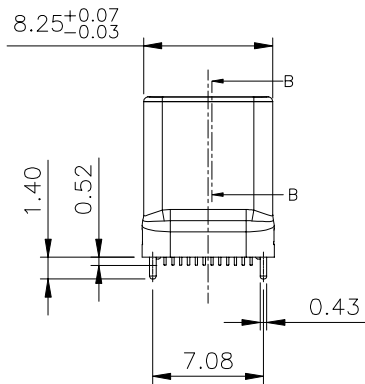
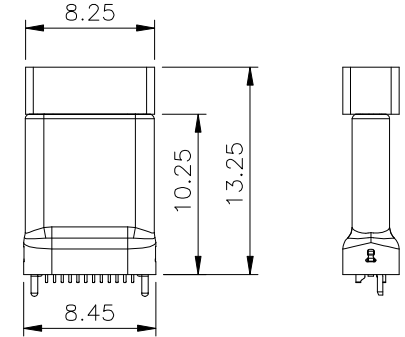

RECOMMEND P.C.B LAYOUT
TOLERANCES: ±0.05;
PCB T=0.80mm

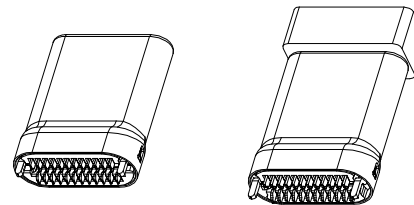
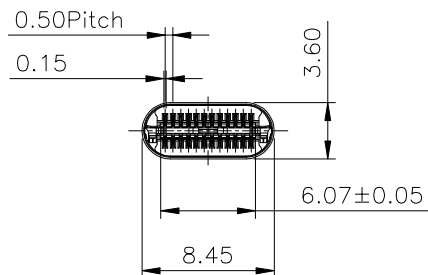

DIM	TOL	DIM	TOL
.x	±0.30	.x	±2°
.x	±0.25	.x	±1°
.xx	±0.15		



DEREN
SHENZHEN DEREN ELECTRONIC CO., LTD

DRAW NO.

CUSTOMER	DRAWING	DATE
DESIGN:	Liangkeyao	2019.02.27
CHECK:		
APPROVAL:		

TITLE: UC PLUG ALL CLOSE ASSY 3.6H 24PIN_ONLY CONN		
P/N:	40-42415-CA00xTxxxxx	
SHEET:	1/2	
SCALE:	1:1	UNIT: mm

HF

Halogen Free

NOTES:

1. MATERIAL

1.1 HSG: HIGH TEMPERATURE THERMOPLASTIC UL94V-0;

COLOR: SEE PART NUMBER INFORMATION

1.2 CONTACT: COPPER ALLOY

1.3 LATCH: STAINLESS STEEL

1.4 SHELL: STAINLESS STEEL

2. FINISH:

2.1 CONTACT:

SEE PART NUMBER INFORMATION MIN, Au PLATING ON CONTACT AREA.

100u" [2.54um] MIN. TIN PLATING ON SOLDER TAIL AREA.

80u" [2.03um] MIN. NICKEL UNDERPLATING ON ALLOVER AREA.

2.2 SHELL

SEE PART NUMBER INFORMATION

2.3 LATCH:

100u" [2.54um] MIN. TIN PLATING ON SOLDER TAIL AREA.

50u" [1.27um] MIN. NICKEL UNDERPLATING ON ALLOVER AREA.

3. MATING FORCE: 5~20N;

UNMATING FORCE: 8~20N (0~1000 CYCLES) AND 6~20N AFTER 10000 CYCLES;

(MATING FORCE/UNMATING FORCE TEST MUST ASSEMBLE PCBA)

4. DIELECTRIC WITHSTANDING VOLTAGE: 300V AC/MINUTE FOR PER PIN

5. INSULATION RESISTANCE: 100M OHM BETWEEN ADJACENT CONTACTS AT 300V DC

6. LLCR: INITIAL: 40 MLLIOHM MIN FOR GAN,VBUS AND OTHERS PIN. 50 MLLIOHM MAX

ATFER ENVIRONMENTAL STRESSES.

7. DATE CODE INFORMATION:

DEREN X XX XX X

ASSEMBLY LINE

DAY: 01~07 (SUN:01;MON:02)

WEEK: 01~53

YEAR: 0~9

LOGO: DEREN

PINS DESCRIPTION

PLUG FRONT VIEW

A12	A11	A10	A9	A8	A7	A6	A5	A4	A3	A2	A1
GND	RX2+	RX2-	VBUS	SBU1	D-	D+	CC	VBUS	TX1-	TX1+	GND
GND	TX2+	TX2-	VBUS	Vconn			SBU2	VBUS	RX1-	RX1+	GND
B1	B2	B3	B4	B5	B6	B7	B8	B9	B10	B11	B12

REV.	ECN NO.	LOCATION	DESCRIPTION	DATE	DESIGN
X1			INITIAL RELEASE	2019.02.27	Liangkeyao
					Liangkeyao

8. PART NUMBER INFORMATION:

40-42415-C A 00 * T * * * **

RESERVE NUMBER:

SHELL PLATING:

0,A: PEARL NICKEL

1,B: NICKEL

2,C: GOLD(G/F)

3,D: SAND BLAST

LOGO:

0: WITH LOGO & WITHOUT EMI SPRING

1: WITHOUT LOGO & WITHOUT EMI SPRING

2: WITH LOGO & WITH EMI SPRING

3: WITHOUT LOGO & WITH EMI SPRING

HOUSING COLOR:

0: BLACK

1: WHITE

2: RED

3: YELLOW

PACKAGE CODE:

T: TRAY PACKING

R: REEL PACKING

N: NO PACKING

PLATING CODE:

1: Au:30u"

2: G/F

3: Au:5u"

4: Au:10u"

5: Au:15u"

ASSY MOLD:

0: ONLY PLUG CONN

PIN NUMBER CODE:

A: 24PINS

DIM	TOL	DIM	TOL
x.	±0.30	x.	±2°
.x	±0.25	.x	±1°
.xx	±0.15		

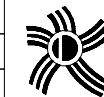
**DEREN**

SHENZHEN DEREN ELECTRONIC CO., LTD

CUSTOMER DRAWING DATE

DESIGN: Liangkeyao 2019.02.27

CHECK:

APPROVAL:

REV. X1

TITLE: UG PLUG ALL CLOSE ASSY
3.6H 24PIN_ONLY CONN

P/N: 40-42415-CA00xTxxxxx

SHEET: 2/2

SCALE: 1:1 UNIT: mm

UNIT: mm

HF
Halogen Free

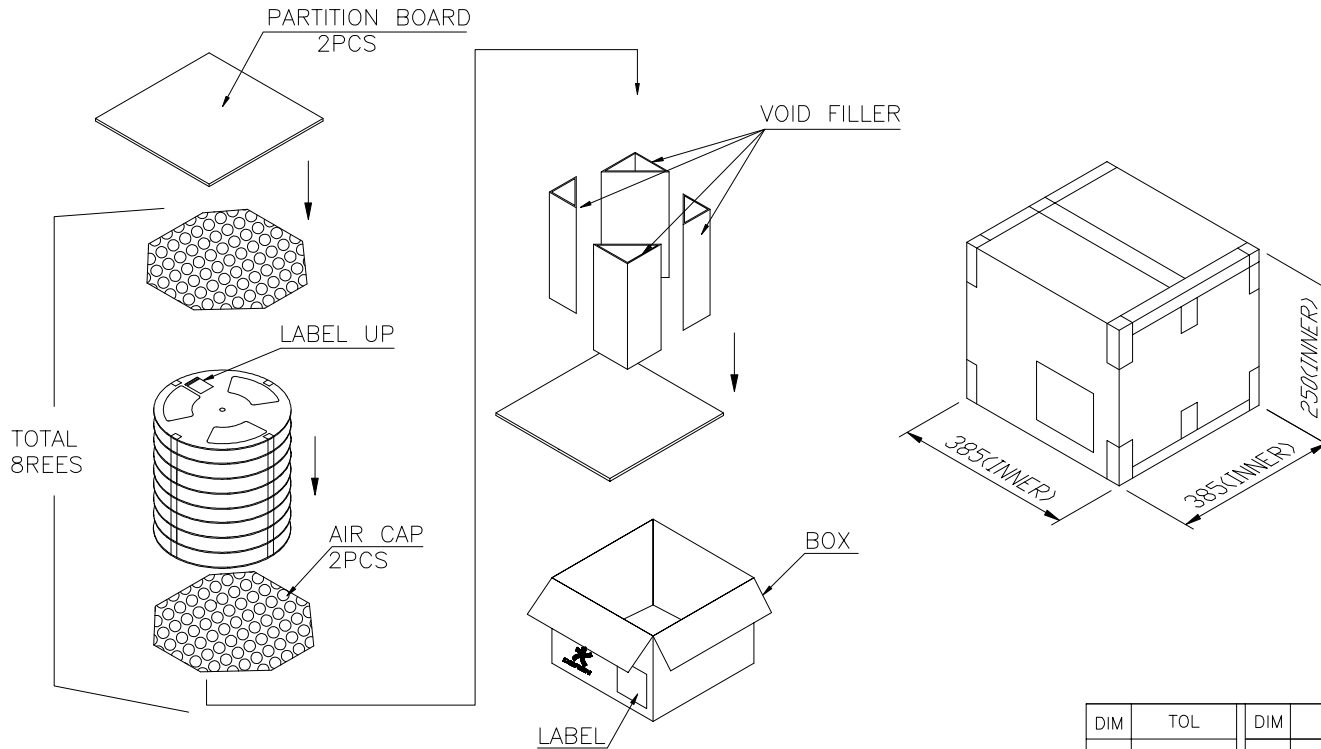
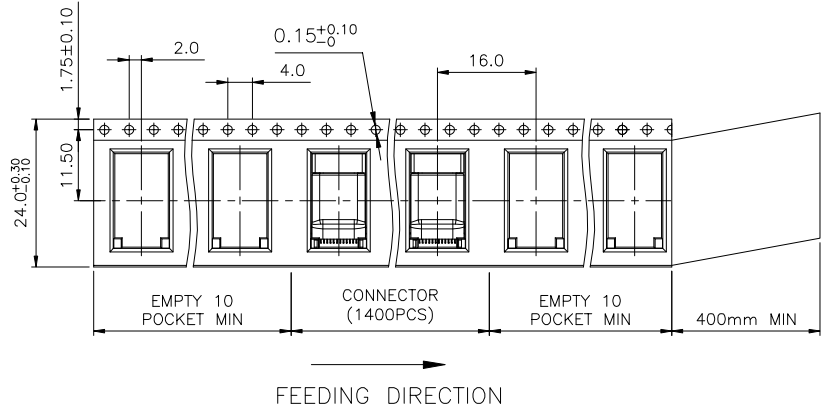
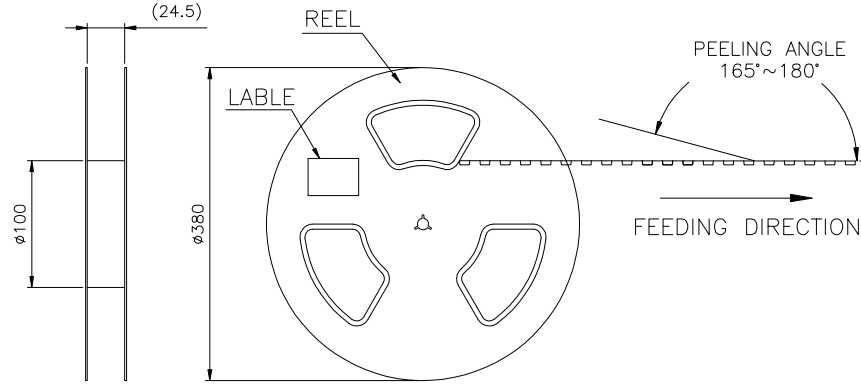

备注:

1. 产品包装按照1400PCS/卷,前、后各留10PCS空格,上载带比下载带多留400mm Min; 8卷/箱,共计11200PCS/箱;
2. 卷盘上、下方各放1PCS气泡垫和纸板,纸箱4个角各放1个角卡;
3. 每个卷盘上都需要贴物料标签,封箱后在外箱贴上标签,如图示;

DIM	TOL	DIM	TOL
x.	±0.30	x.	±2"
.x	±0.25	.x	±1"
.xx	±0.15		

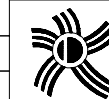

DEREN
SHENZHEN DEREN ELECTRONIC CO., LTD

DRAW NO.		DATE		TITLE:	
***		2019.02.27		UC PLUG ALL CLOSE ASSY 3.6H 24PIN_ONLY CONN	
REV.	X1	DESIGN:	Liangkeyao	P/N:	40-42415-CA00xTxxxxx
		CHECK:		SHEET:	N/A
		APPROVAL:		SCALE:	1:1
				UNIT:	mm

HF
Halogen Free

REV.	ECN NO.	LOCATION	DESCRIPTION	DATE	DESIGN
X1			INITIAL RELEASE	2019.02.27	Liangkeyao
					Liangkeyao

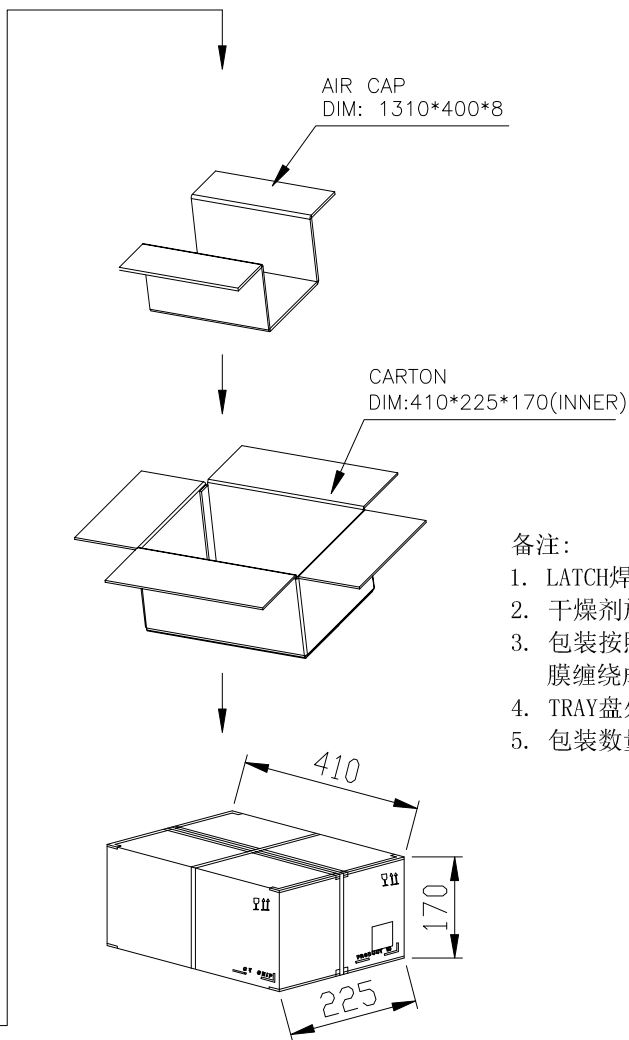
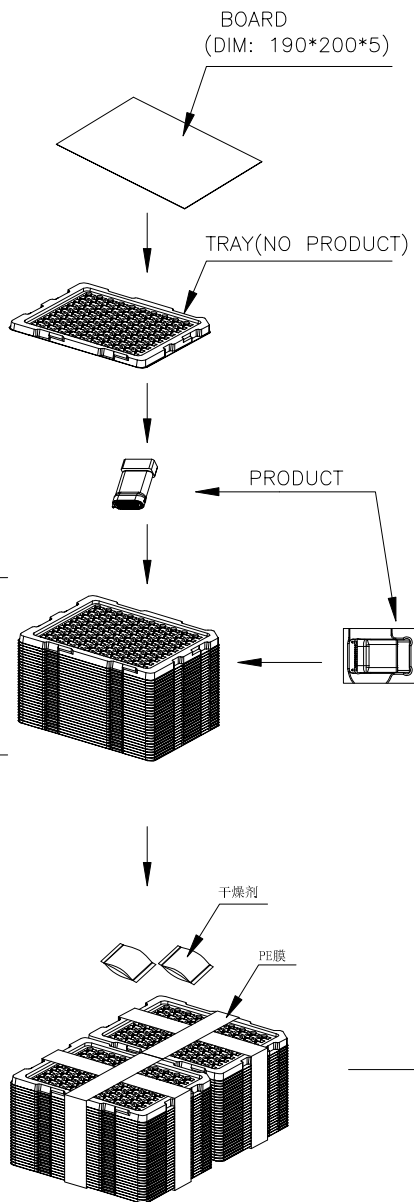

备注:

1. LATCH焊脚朝上, 须保持产品朝向一致置入盘中;
2. 干燥剂放置PE袋内, PE袋收口时折叠好;
3. 包装按照100PCS/盘, 60盘/箱, 顶层放1PCS空盘, 30盘/捆并用PE膜缠绕成十字型, 2捆/箱 (共计: 60盘/箱, 两个空盘);
4. TRAY盘外裹1PCS AIR CAP, 最后封箱贴上标签, 如图示;
5. 包装数量: 60盘/箱(即6000PCS/箱);

DIM	TOL	DIM	TOL
x.	±0.30	x.	±2*
.x	±0.25	.x	±1*
.xx	±0.15		



DEREN
SHENZHEN DEREN ELECTRONIC CO., LTD

CUSTOMER	DRAWING	DATE	TITLE: UC PLUG ALL CLOSE ASSY 3.6H 24PIN_ONLY CONN
DESIGN:	Liangkeyao	2019.02.27	P/N: 40-42415-CA00xTxxxxx
CHECK:			SHEET: N/A
APPROVAL:			SCALE: 1:1 UNIT: mm

REV. X1